



Please note that these instructions are guidelines only and in no way supersede any construction or installation standards.
Local building and electrical codes should be consulted before installation.

ATTENTION

- There is potential danger of electrical shock when operating electrical components.
- Make sure power is turned off before installation.
- Allow for heat dissipation and adequate ventilation.

COMPONENTS

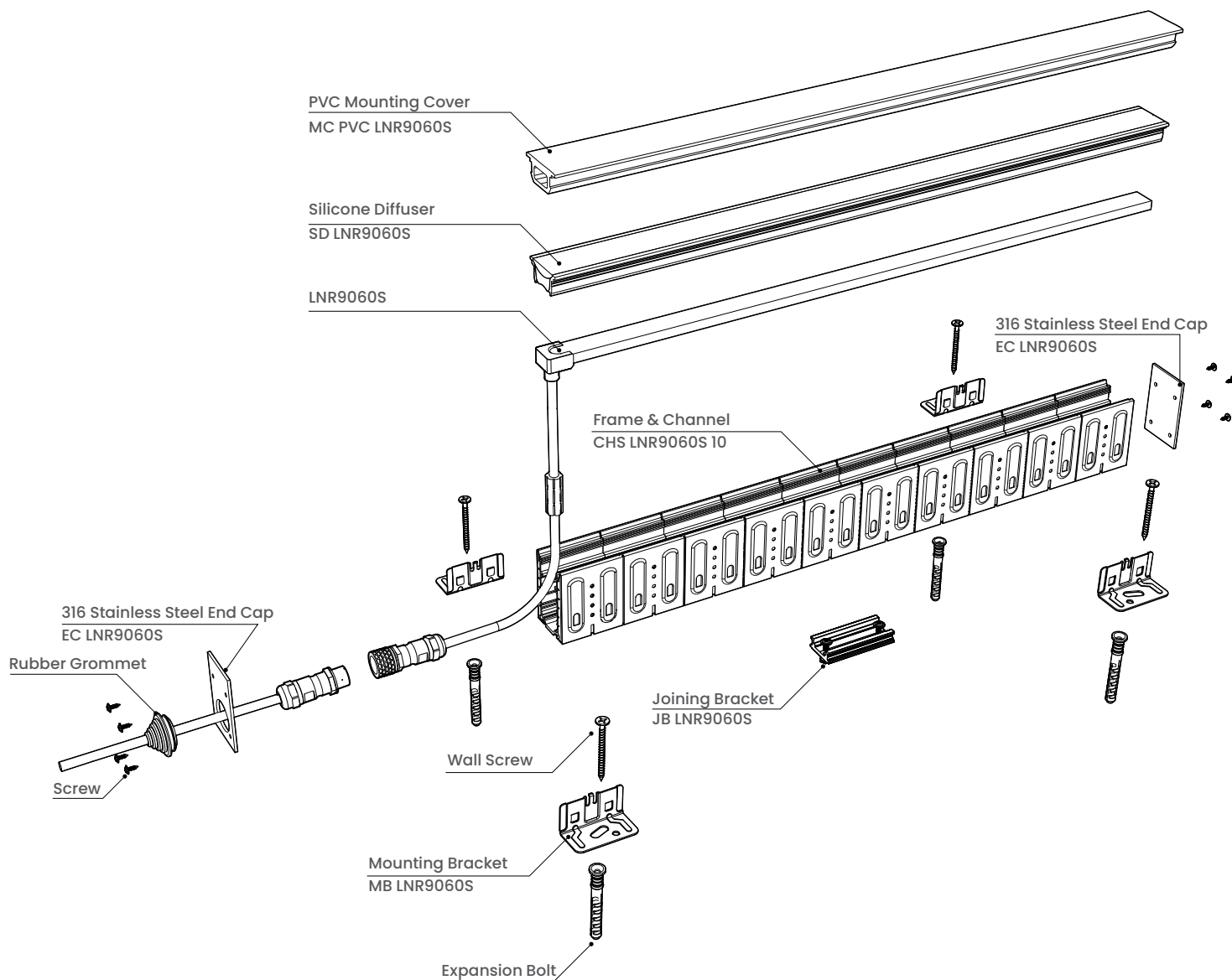

SLOTTING

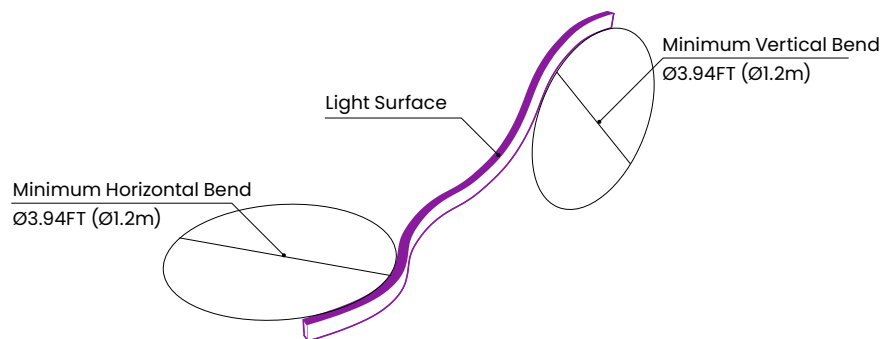
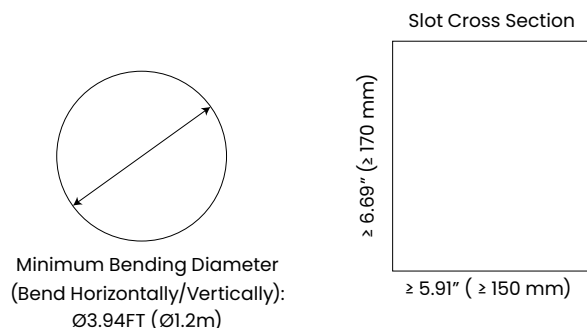
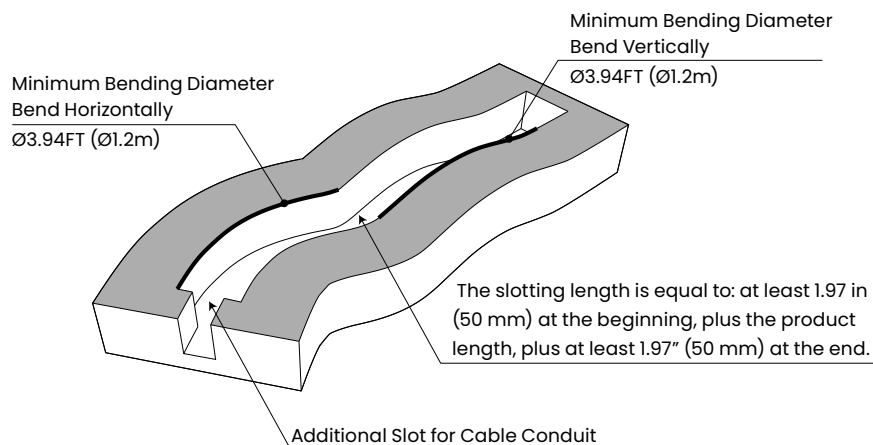

DRAINAGE CONSTRUCTION

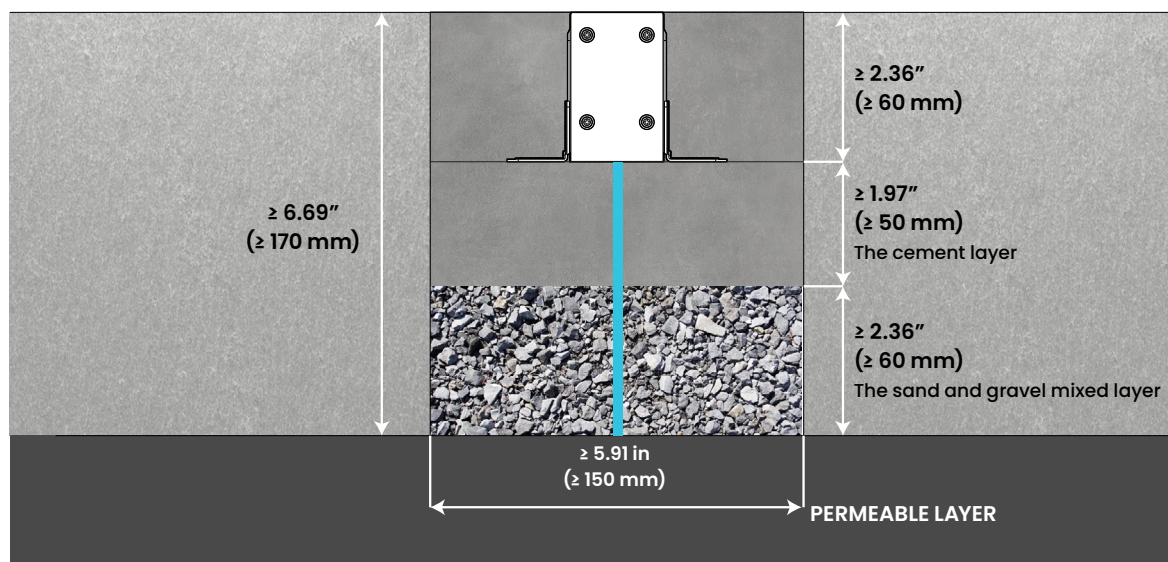

CUTTING PROFILE

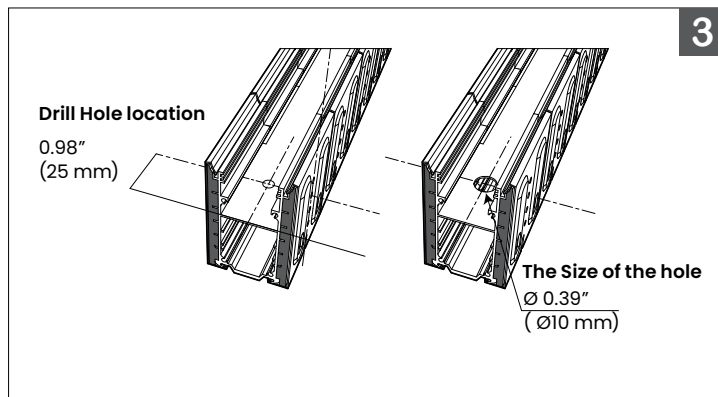
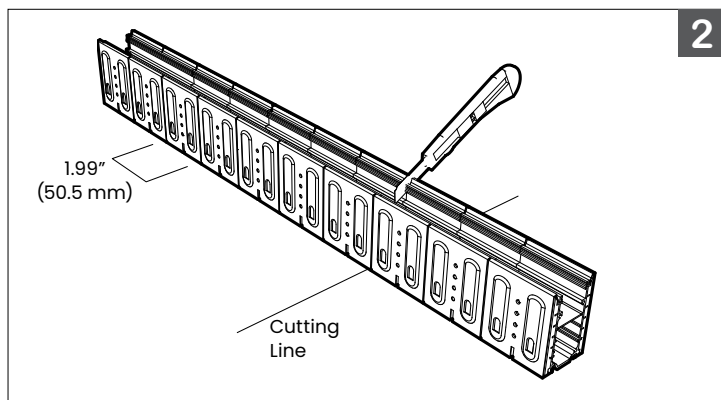
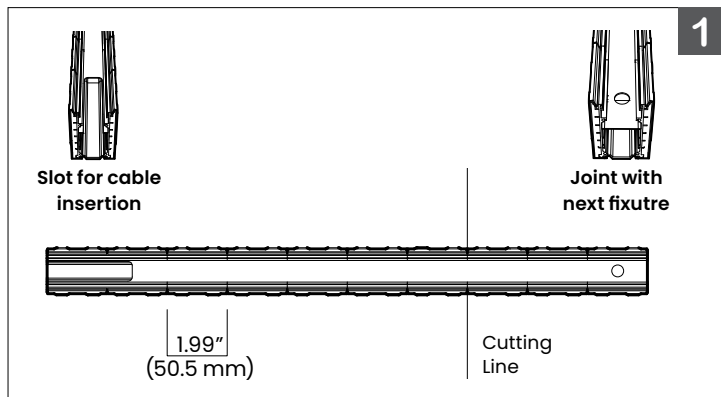

1. Identify the two ends of the profile—one end has a front slot for cable insertion, and the other has a hole for joining with the next fixture. Cut from the side with the connection hole.
2. After measuring the total required length, cut the profile from the connection end, following 1.99" (50.5 mm) increments to ensure alignment.
3. Drill a $\varnothing 0.39"$ (10 mm) hole, positioned 0.98" (25 mm) from the cut edge, to prepare for bracket installation.

JOINING PROFILE

1-2.
Insert the joining bracket halfway into the first profile and secure it with a screw through the pre-drilled hole.

3.
Slide the second profile onto the exposed bracket until both ends are flush.

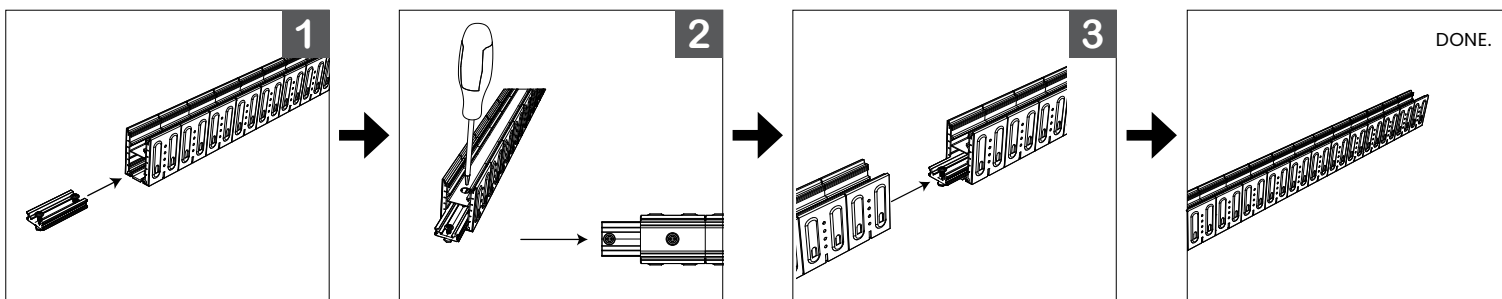

INSTALLATION

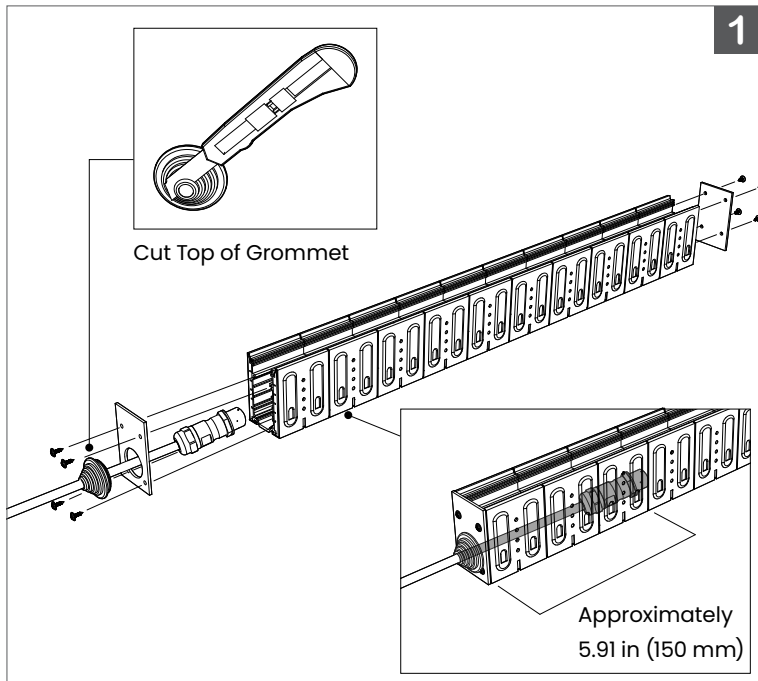

1.

Cut the top of the rubber grommet and insert the wire through it. Secure the end cap to the profile using screws.

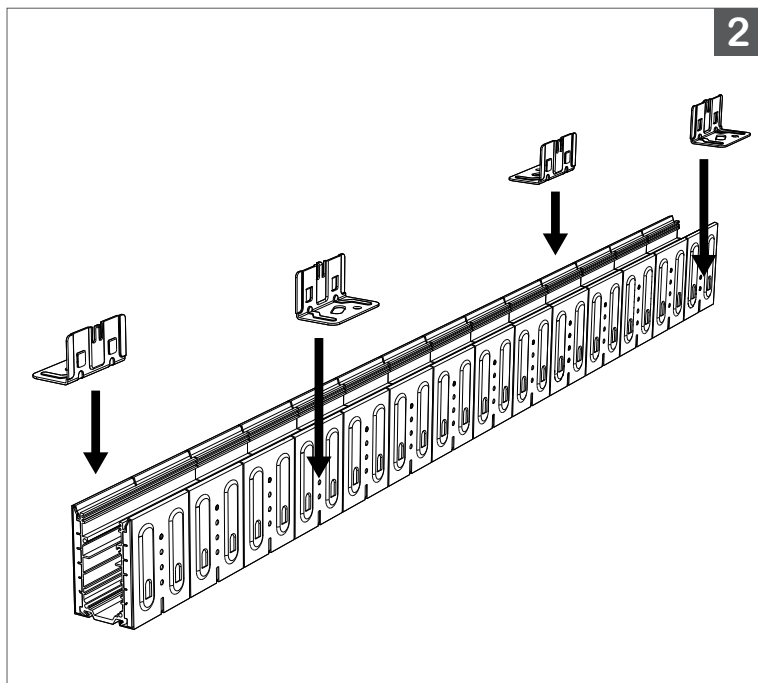
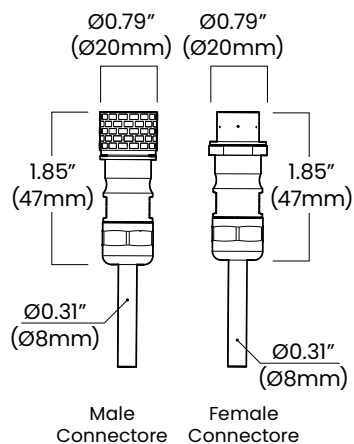

2.

Insert 6 fixing brackets per meter, positioned evenly and alternately on both sides.

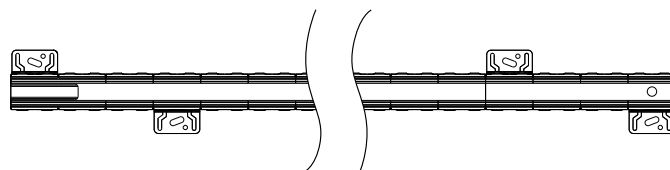

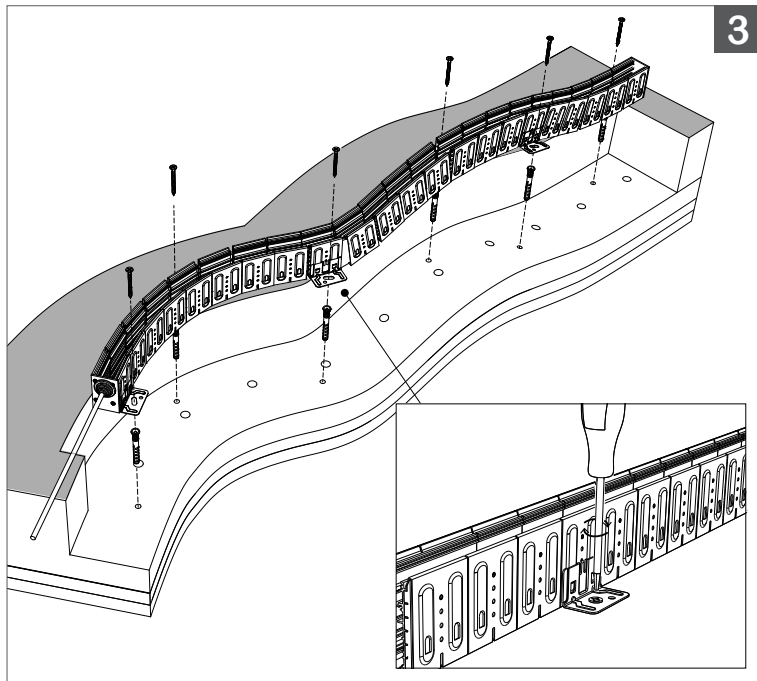

3.

Install the mounting bracket into the prepared slot. Use Expansion Bolts and screws to fix it firmly in place.

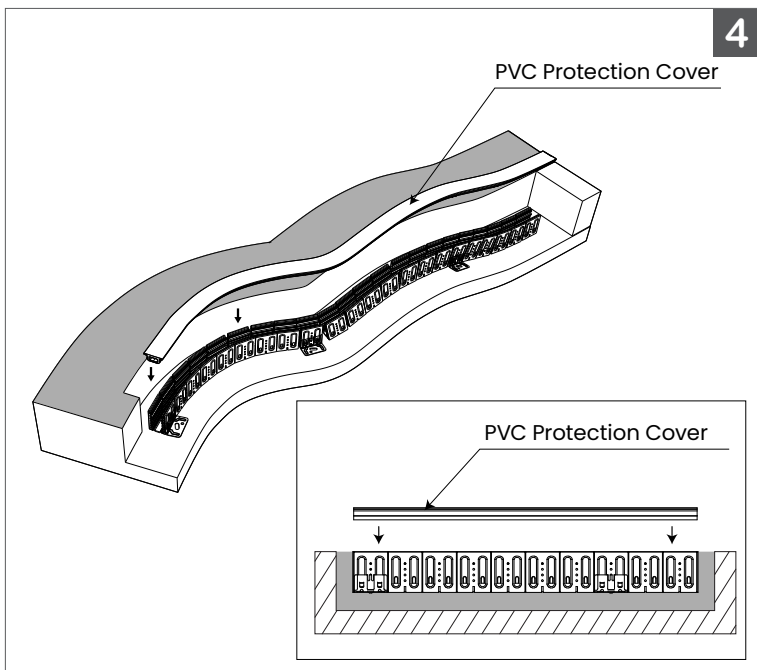

4.

Place the PVC protection cover over the profile to prevent cement from entering during construction and prepare for the next step.



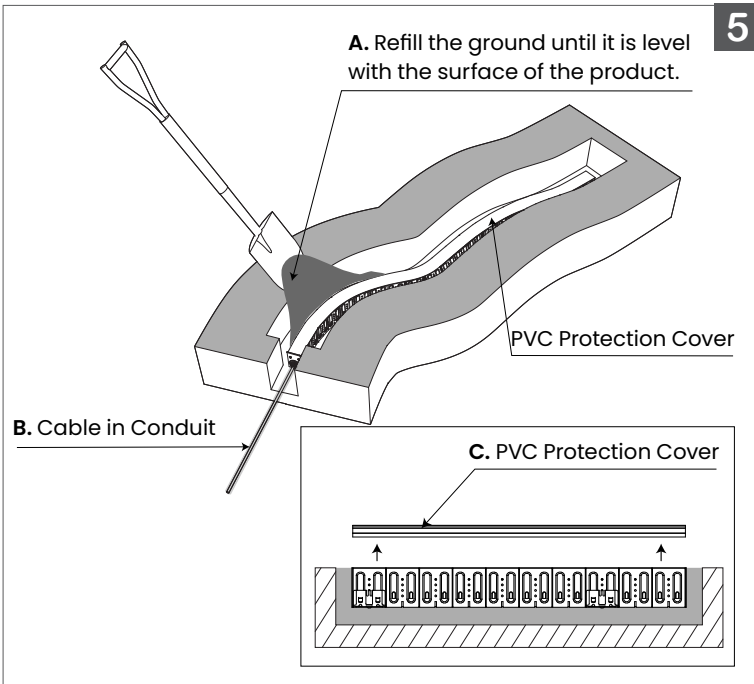

5

5.

A. Pour and level the concrete or cement around the profile as needed. Wait for it to fully cure.

B. Fully encase the cable in the conduit to prevent cement from hardening around it and causing blockages.

C. Once the surface is dry, remove the PVC protection cover.

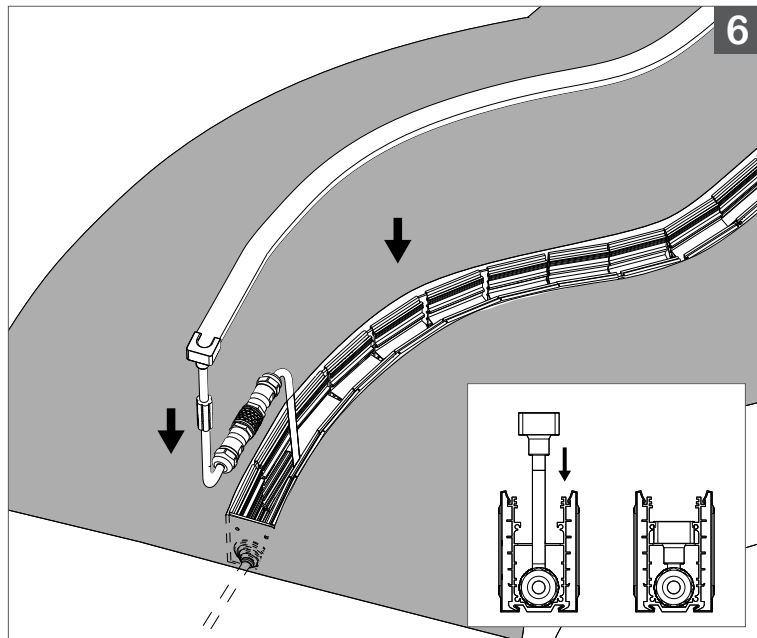
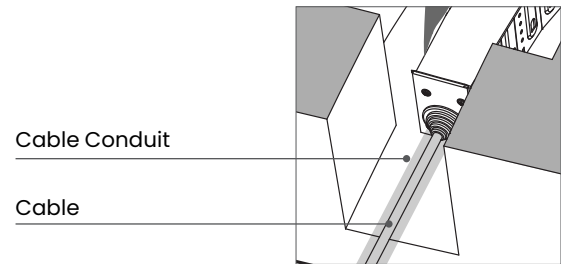

6

6.

Insert the lighting unit into the installed channel.



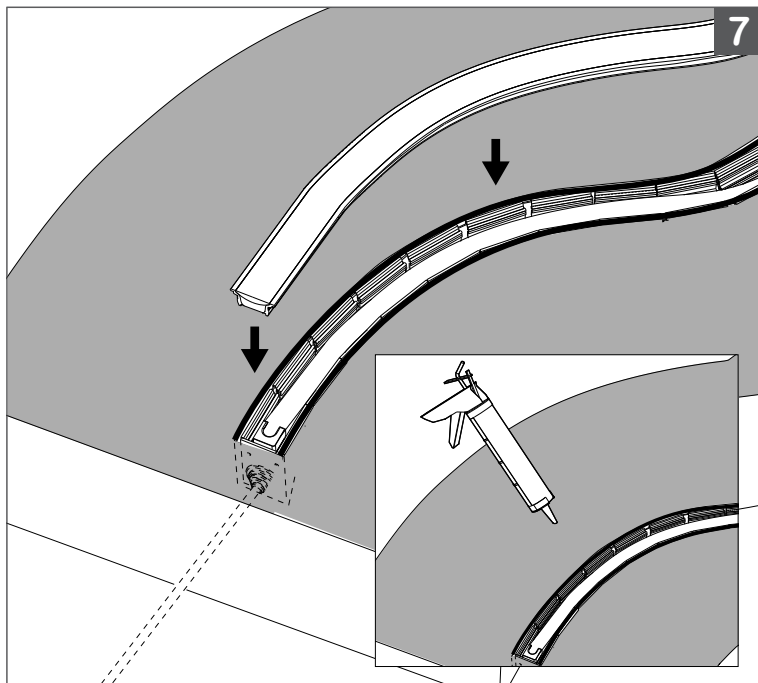

7.

Apply the structural adhesive along the edge of the profile at both ends, with a gluing length of approximately 5 cm, to ensure the silicone diffuser remains securely in place.

NOTE: For optimal performance, it is highly recommended to use adhesives such as Dow Corning SJ168, 791, or 995.

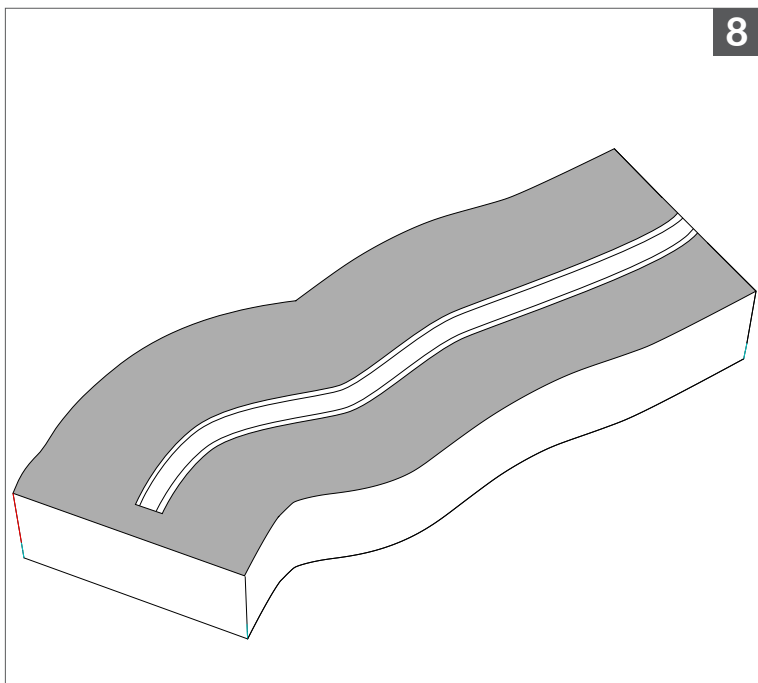

8.

DONE.

