

Back Lead

Top View

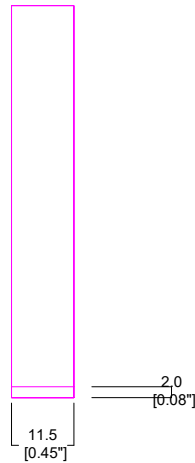

Front View

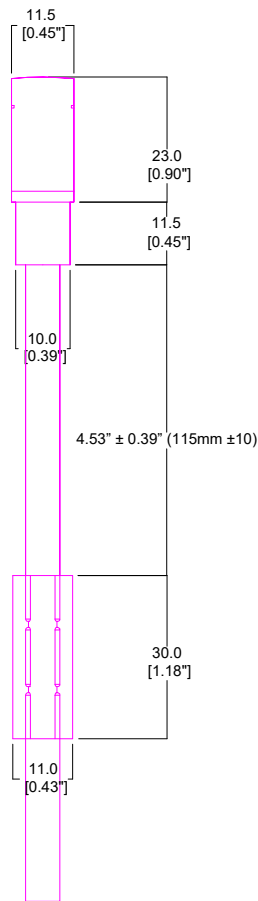

Side View

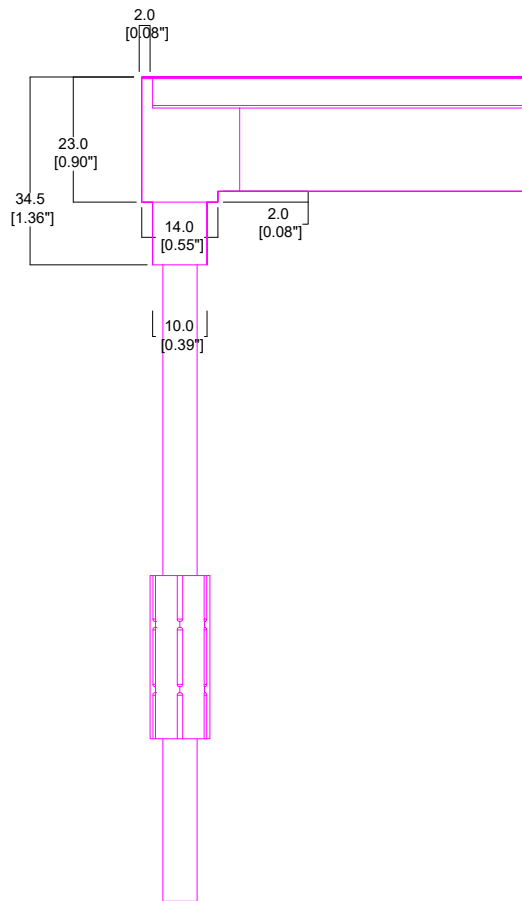

CAD Drawing subject to change without notice.



End Lead

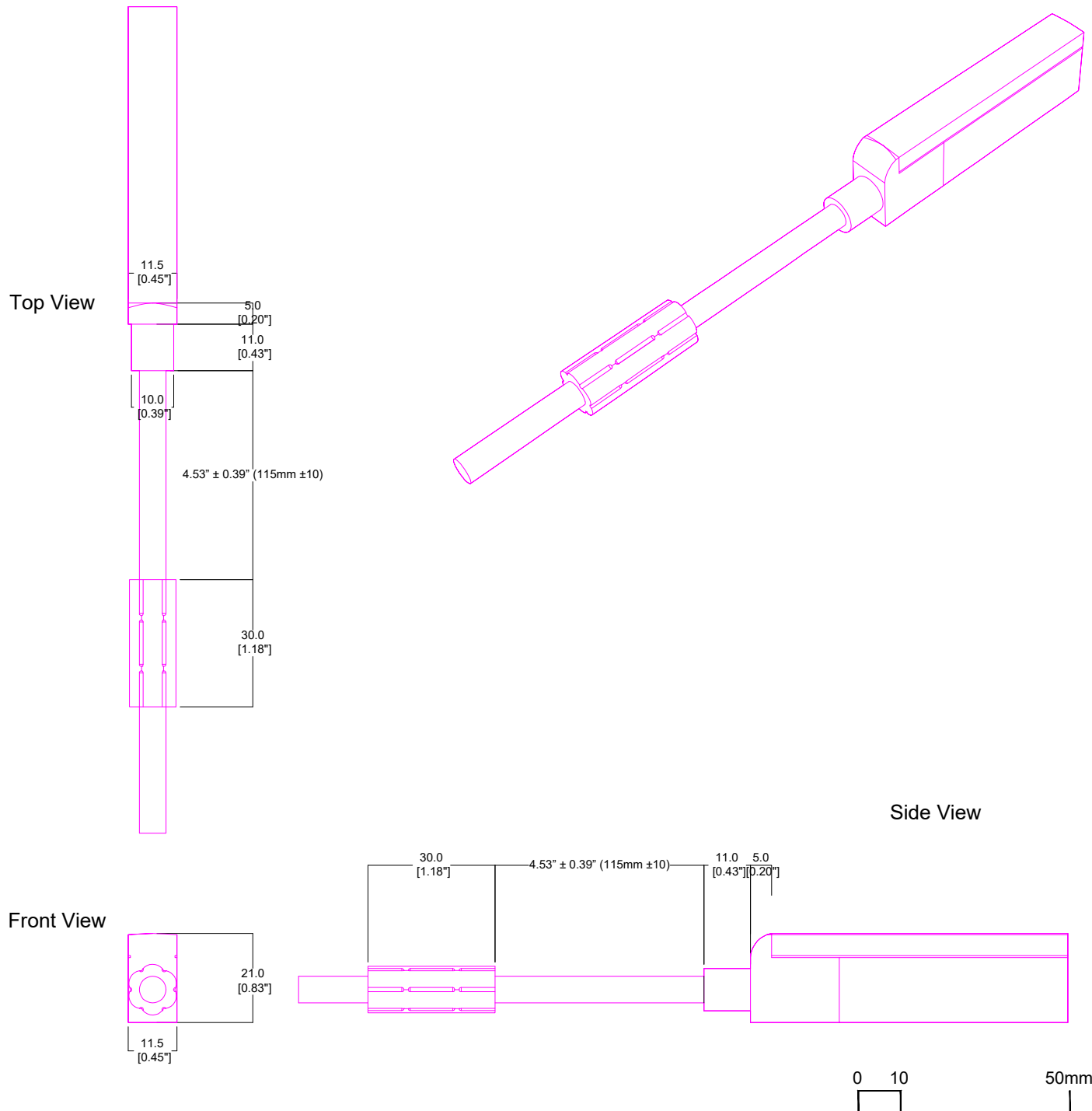

CAD Drawing subject to change without notice.



Left Side Lead

Top View

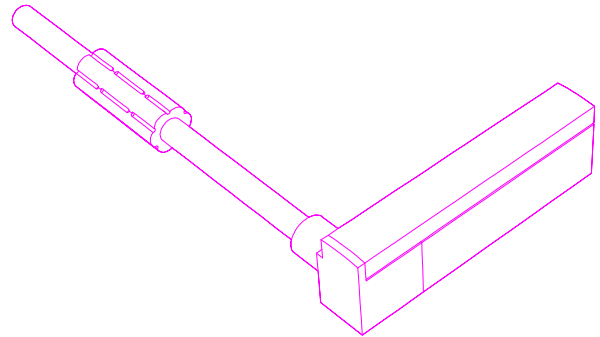
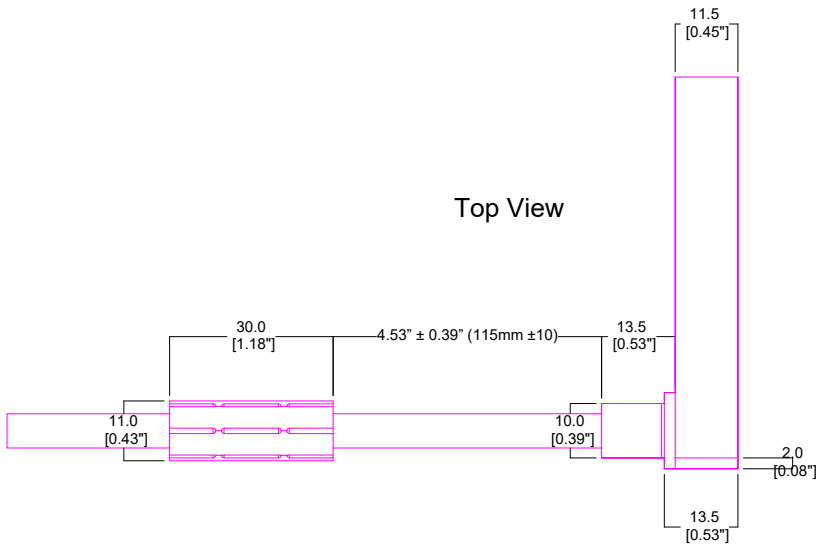

Right Side View



Front View

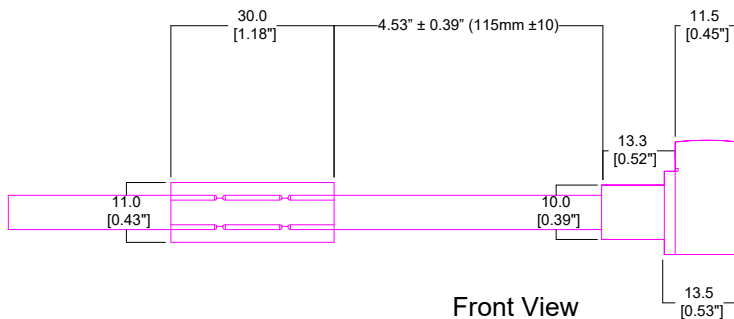

Left Side View

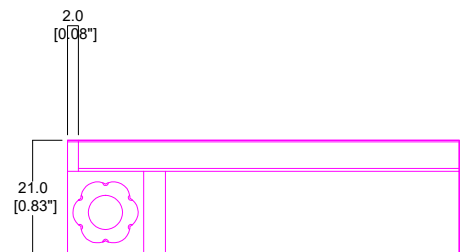

CAD Drawing subject to change without notice.



Right Side Lead

Top View

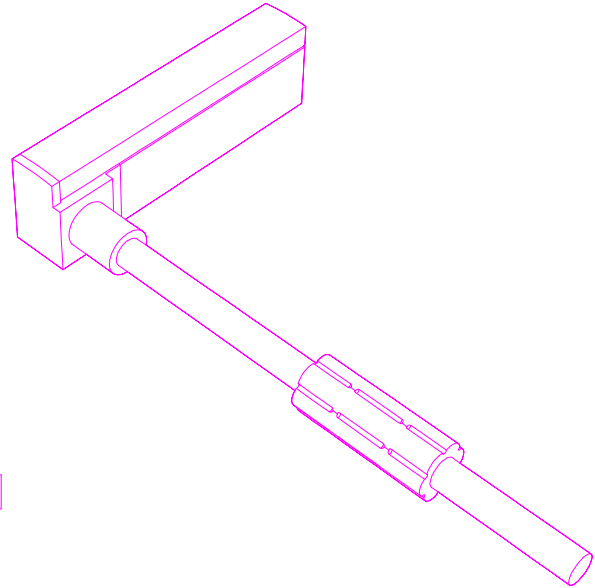
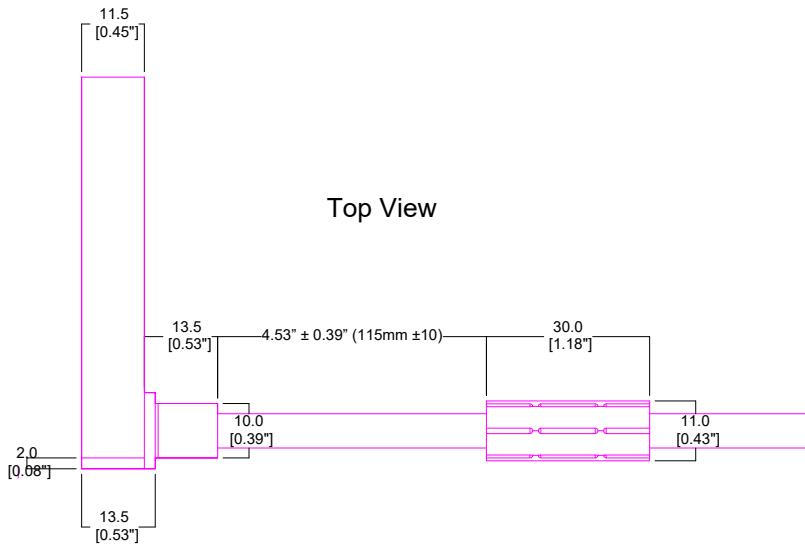

Front View

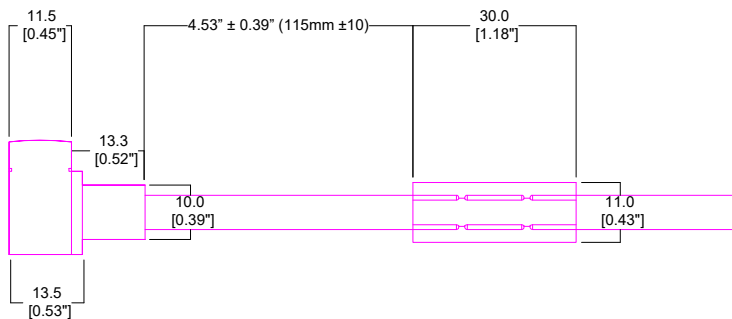

Right Side View



CAD Drawing subject to change without notice.



End cap

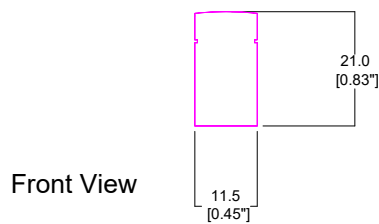
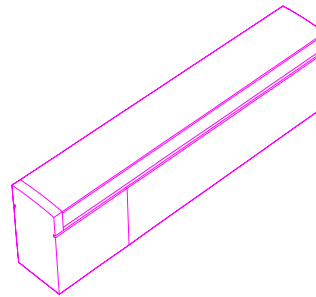
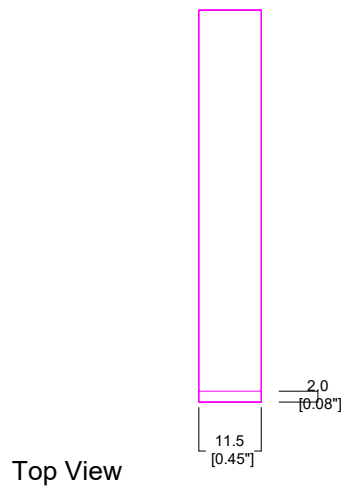

Side View



CAD Drawing subject to change without notice.

