



Please note that these instructions are guidelines only and in no way supersede any construction or installation standards.
Local building and electrical codes should be consulted before installation.

ATTENTION

- There is potential danger of electrical shock when operating electrical components.
- Make sure power is turned off before installation.
- Allow for heat dissipation and adequate ventilation.

INSTALLATION LAYOUT

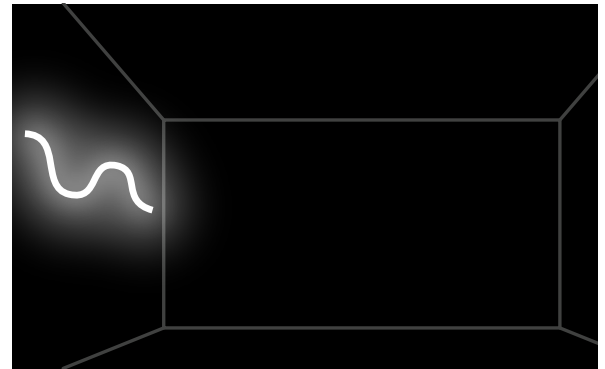
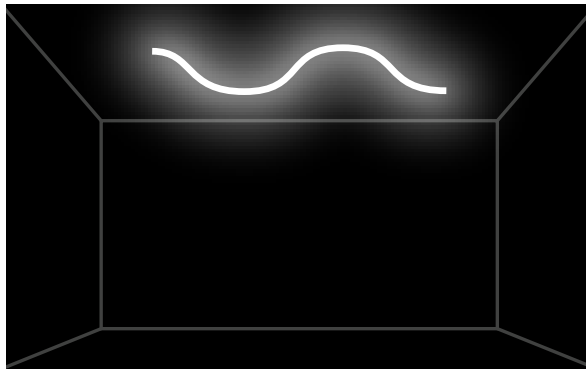

COMPONENTS

Mounting Clip (1)

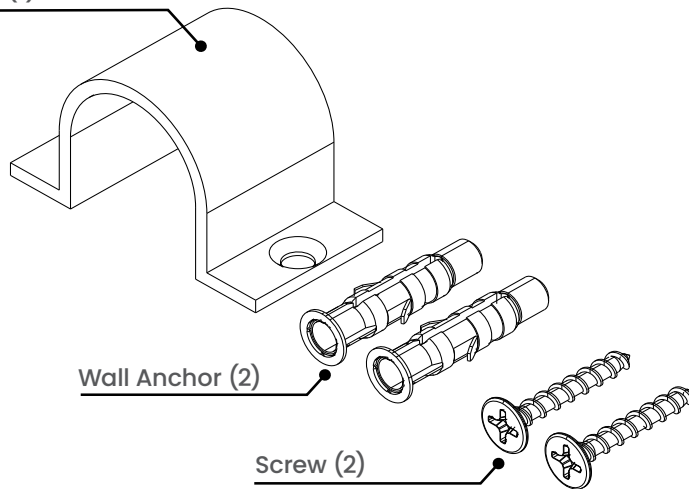

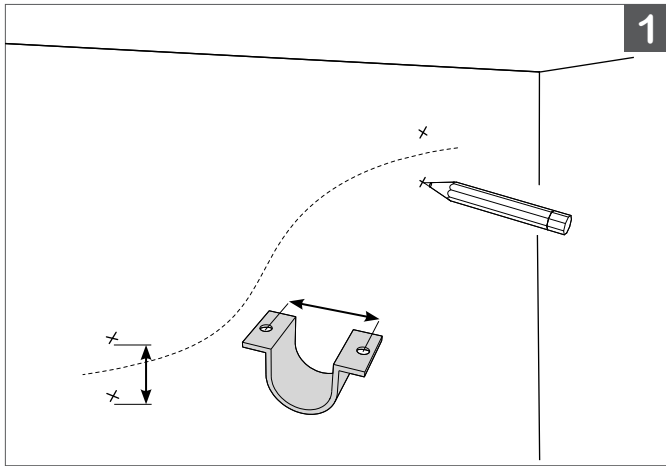

1.

Draw the centerline for the desired shape of the **N360** product.

Using the mounting clip as a guide, mark drill holes position.

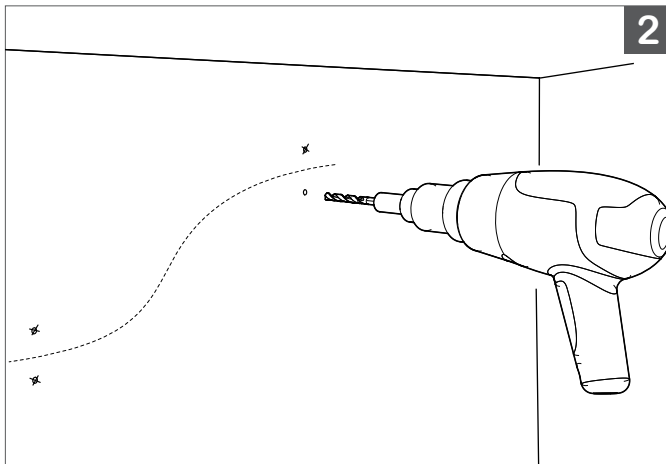

2.

Drill holes at the marked positions for the mounting clips.

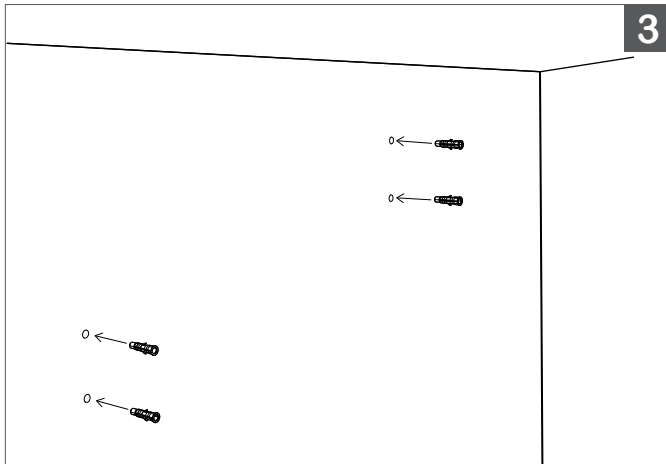

3.

Insert anchors into the drilled holes.



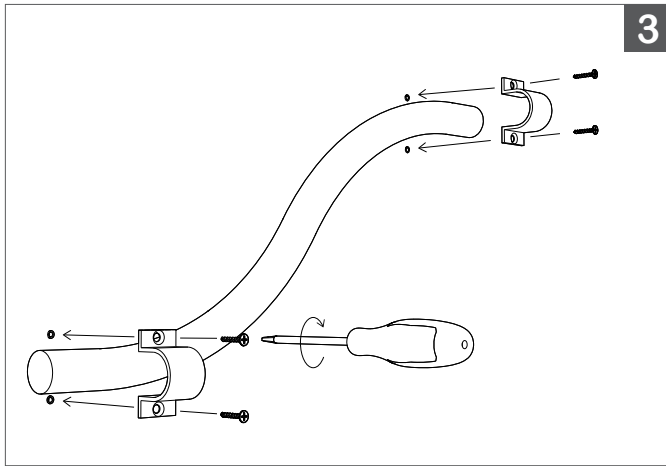

3.

Slide the mounting clip onto the **N360** product and align the screw hole of the clip with the pre-drilled holes on the wall.

Using a screwdriver, secure each mounting clip with two screws until the light is firmly installed. Ensure all screws are tightened evenly for a secure installation.

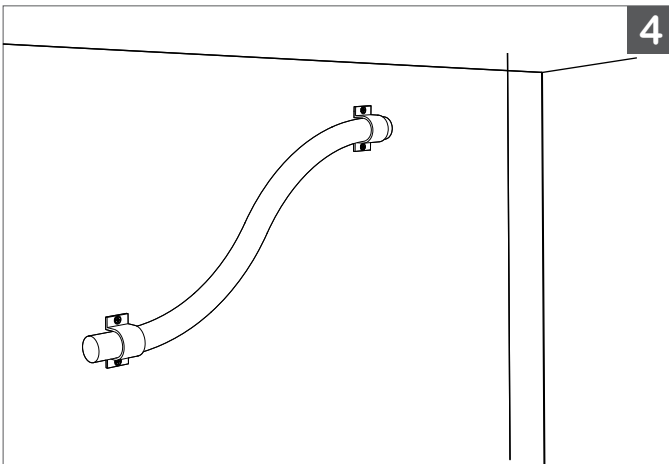

4.

DONE.

