

## BL fixFORM RC Series

Indoor Recessed Aluminium Extrusion  
Designed for use with **BL flexFORM** Series

20

Printed

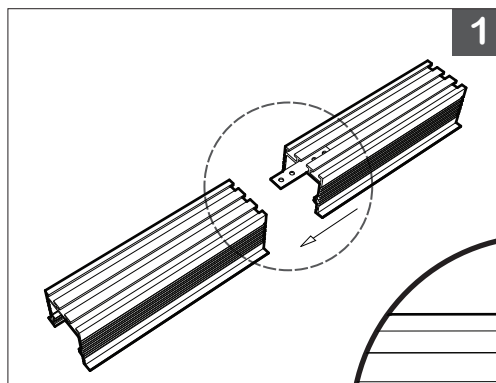

If required length is less than stock length (6'), please skip Step 1.

1. Combine multiple lengths of **BL fixFORM RC20** with **TC180** connectors.

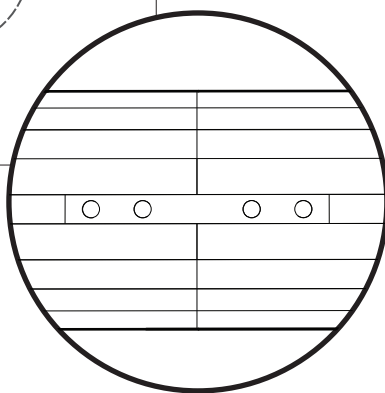

**IMPORTANT:** Do not over tighten hex bolts as it may damage **BL fixFORM RC20** base track.

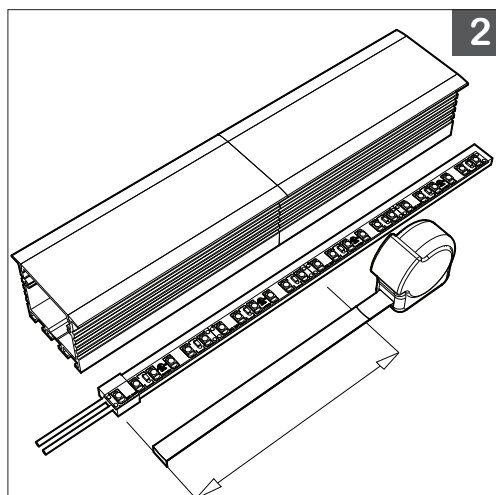

2.

A. Measure **BL fixFORM RC20** in parallel with **BL flexFORM Series** to guarantee accurate coupling of components.  
B. Cut **BL fixFORM RC20**.

**TIP:** Cut **BL fixFORM RC20** optic and base track simultaneously.

PROJECT

CLIENT

TYPE

Solid State Lighting is sensitive to power fluctuations  
Surge protection is highly recommended for all LED lighting products and should be on a designated circuit to protect against premature failure  
Lack of surge protection may void your warranty

For more information, please download the  
**BL LIGHTING** catalogue

**BL LIGHTING. ILLUMINATE EVERYTHING**

111 - 8838 Heather St. Vancouver, BC, Canada. V6P 3S8  
P: 1-604-874-4405 F: 1-604-321-0445 E: info@bllighting.com  
Copyright © 2017 BL INNOVATIVE LIGHTING. All Rights Reserved.

bllighting.com



## BL fixFORM RC Series

Indoor Recessed Aluminium Extrusion  
Designed for use with **BL flexFORM Series**

20

Printed

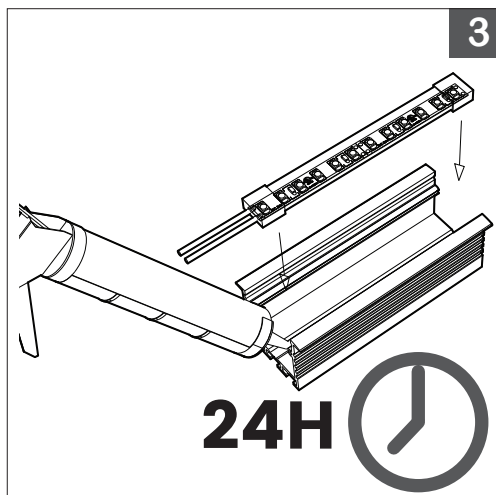

3.

- A. Evenly bead adhesive along surface of **BL fixFORM RC20** base track.
- B. Mount **BL flexFORM Series** into base track.

**IMPORTANT:** Allow adhesive to cure for 24 hours before installation.

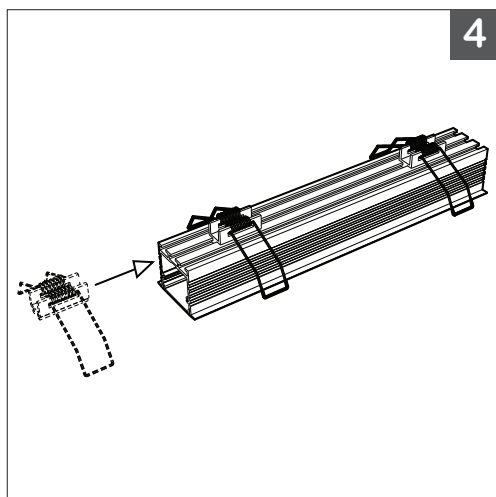

- 4. Insert Spring Clip into groove on the back of the base track.

**TIP:** Minimum two Spring Clips per section recommended for secure fit behind drywall.

PROJECT

CLIENT

TYPE

Solid State Lighting is sensitive to power fluctuations  
Surge protection is highly recommended for all LED lighting products and should be on a designated circuit to protect against premature failure  
Lack of surge protection may void your warranty

For more information, please download the  
**BL LIGHTING** catalogue

**BL LIGHTING.** ILLUMINATE EVERYTHING

111 - 8838 Heather St. Vancouver, BC, Canada. V6P 3S8  
P: 1-604-874-4405 F: 1-604-321-0445 E: info@bllighting.com  
Copyright © 2017 BL INNOVATIVE LIGHTING. All Rights Reserved.

[bllighting.com](http://bllighting.com)



## BL fixFORM

Indoor Recessed Aluminium Extrusion  
Designed for use with **BL flexFORM** Series

## RC20

Printed

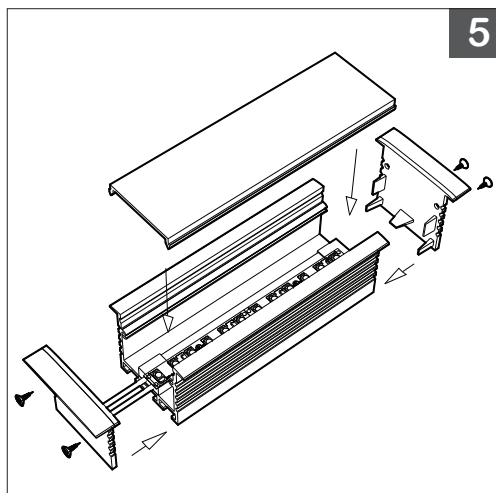

5.

- A. Install optic onto base track.
- B. Feed **BL flexFORM Series** power lead through designated hole on **BL fixFORM RC 20** end cap.
- C. Harness end caps onto base track with screws.

PROJECT

CLIENT

TYPE

Solid State Lighting is sensitive to power fluctuations  
Surge protection is highly recommended for all LED lighting products and should be on a designated circuit to protect against premature failure  
Lack of surge protection may void your warranty

For more information, please download the  
**BL LIGHTING** catalogue

**BL LIGHTING. ILLUMINATE EVERYTHING**

111 - 8838 Heather St. Vancouver, BC, Canada. V6P 3S8  
P: 1-604-874-4405 F: 1-604-321-0445 E: info@bllighting.com  
Copyright © 2017 BL INNOVATIVE LIGHTING. All Rights Reserved.

**bllighting.com**

