

## BL fixFORM RC Series

Indoor Recessed Aluminium Extrusion  
Designed for use with BL flexFORM Series

21

Printed

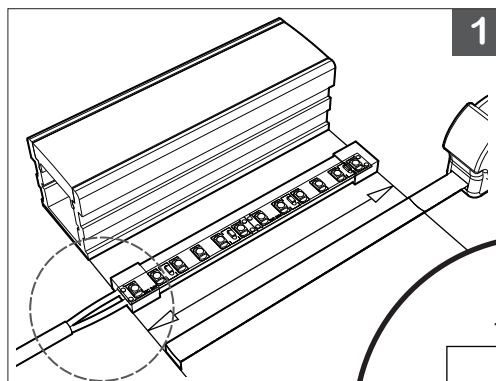

1

1.

- A. Measure **BL fixFORM RC21** in parallel with **BL flexFORM Series** to guarantee accurate coupling of components.
- B. Cut **BL fixFORM RC21**.

**TIP:** Cut **BL fixFORM RC21** optic and base track simultaneously.

**IMPORTANT:** Strip outer jacket of Direct Burial Cable to expose approx. 1" of conductors for flexibility.

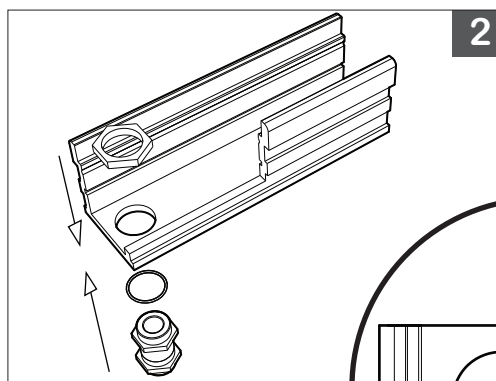
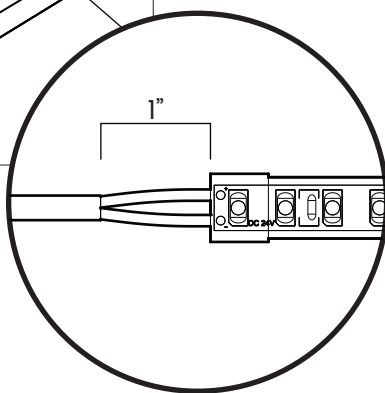

2

2.

- A. Bore a 1/2" hole in the track located approx. 1/8" from the edge.
- B. Install Cable Gland.

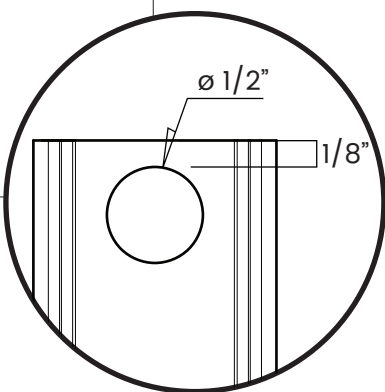

PROJECT

CLIENT

TYPE

Solid State Lighting is sensitive to power fluctuations  
Surge protection is highly recommended for all LED lighting products and should be on a designated circuit to protect against premature failure  
Lack of surge protection may void your warranty

For more information, please download the  
**BL LIGHTING** catalogue

**BL LIGHTING. ILLUMINATE EVERYTHING**

111 - 8838 Heather St. Vancouver, BC, Canada. V6P 3S8  
P: 1-604-874-4405 F: 1-604-321-0445 E: info@bllighting.com  
Copyright © 2017 BL INNOVATIVE LIGHTING. All Rights Reserved.

bllighting.com



## BL fixFORM RC Series

Indoor Recessed Aluminium Extrusion  
Designed for use with **BL flexFORM** Series

21

Printed

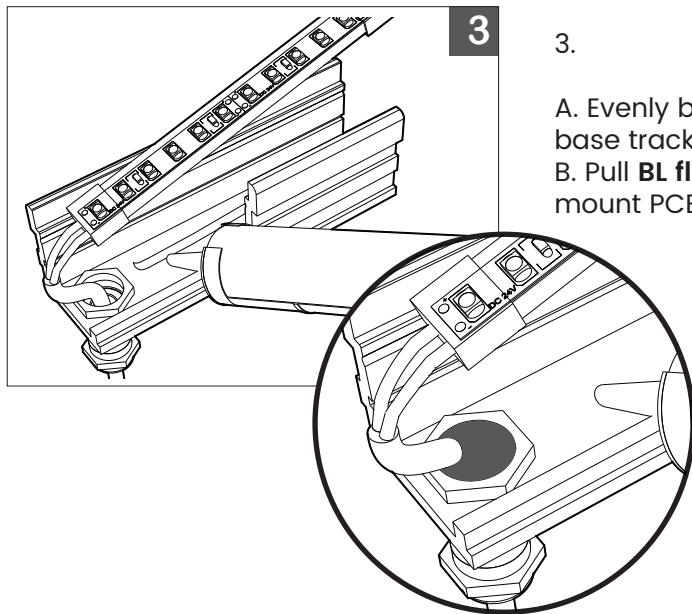

3.

- A. Evenly bead adhesive along surface of **BL fixFORM RC21** base track.
- B. Pull **BL flexFORM Series** leads through Cable Gland and mount PCB onto base track.

**IMPORTANT:** Fill gap in Cable Gland with silicone sealant and tighten.

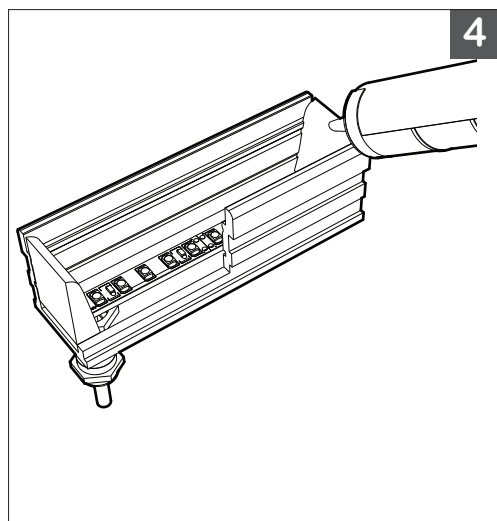

- 4. Create "walls" of silicone sealant on both ends of **BL fixFORM RC21**.

**IMPORTANT:** Be sure to seal any gaps between extrusion and "walls".

PROJECT

CLIENT

TYPE

Solid State Lighting is sensitive to power fluctuations  
Surge protection is highly recommended for all LED lighting products and should be on a designated circuit to protect against premature failure  
Lack of surge protection may void your warranty

For more information, please download the  
**BL LIGHTING** catalogue

**BL LIGHTING.** ILLUMINATE EVERYTHING

111 - 8838 Heather St. Vancouver, BC, Canada. V6P 3S8  
P: 1-604-874-4405 F: 1-604-321-0445 E: info@bllighting.com  
Copyright © 2017 BL INNOVATIVE LIGHTING. All Rights Reserved.

bllighting.com



## BL fixFORM RC Series

Indoor Recessed Aluminium Extrusion  
Designed for use with BL flexFORM Series

21

Printed

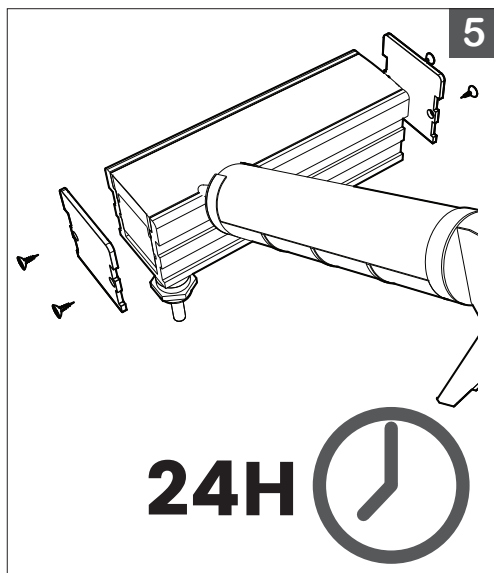

5.

- A. Install optic onto base track.
- B. Harness end caps onto base track with screws.
- C. Bead silicone sealant across edges of the optic.
- D. Clean off any excess silicone sealant while still wet.

**TIP:** Proceed with Step 5 before silicone sealant “walls” can cure to ensure a proper seal.

PROJECT

CLIENT

TYPE

Solid State Lighting is sensitive to power fluctuations  
Surge protection is highly recommended for all LED lighting products and should be on a designated circuit to protect against premature failure  
Lack of surge protection may void your warranty

For more information, please download the  
BL LIGHTING catalogue

**BL LIGHTING. ILLUMINATE EVERYTHING**

111 - 8838 Heather St. Vancouver, BC, Canada. V6P 3S8  
P: 1-604-874-4405 F: 1-604-321-0445 E: info@bllighting.com  
Copyright © 2017 BL INNOVATIVE LIGHTING. All Rights Reserved.

bllighting.com

