

## BL driveLINE SP Series

Surge Protector for Low-Voltage LED Luminaires  
100 - 277VAC, Hardwired

UNI

Printed



### Certification



### Electrical

Input Voltage	100V - 277VAC
Protection	Cat. C3 Surge Location (10kA/10kV)
Surge Current Rating	20,000A, 8/20 $\mu$ Sec Wave
Rating (2mS)	540 Joules
Max. Clamping Voltage	925V
Connections	18 AWG, Copper Conductors

### Strikes

1	22,000A
2	15,000A
10	6,500A
120	3,000A
1000	2,000A

### Mechanical

Housing Construction	Flameproof Plastic Enclosure
Environmental	IP65
Weight	126g (4.4oz)
Cord Length	12"

PROJECT

CLIENT

TYPE

Solid State Lighting is sensitive to power fluctuations  
Surge protection is highly recommended for all LED lighting products and should be on a designated circuit to protect against premature failure  
Lack of surge protection may void your warranty

For more information, please download the  
BL LIGHTING catalogue

BL LIGHTING. ILLUMINATE EVERYTHING

111 - 8838 Heather St. Vancouver, BC, Canada. V6P 3S8  
P: 1-604-874-4405 F: 1-604-321-0445 E: info@blighting.com  
Copyright © 2017 BL INNOVATIVE LIGHTING. All Rights Reserved.

blighting.com



## BL driveLINE SP Series

Surge Protector for Low-Voltage LED Luminaires  
100 - 277VAC, Hardwired

UNI

Printed

## Dimensions

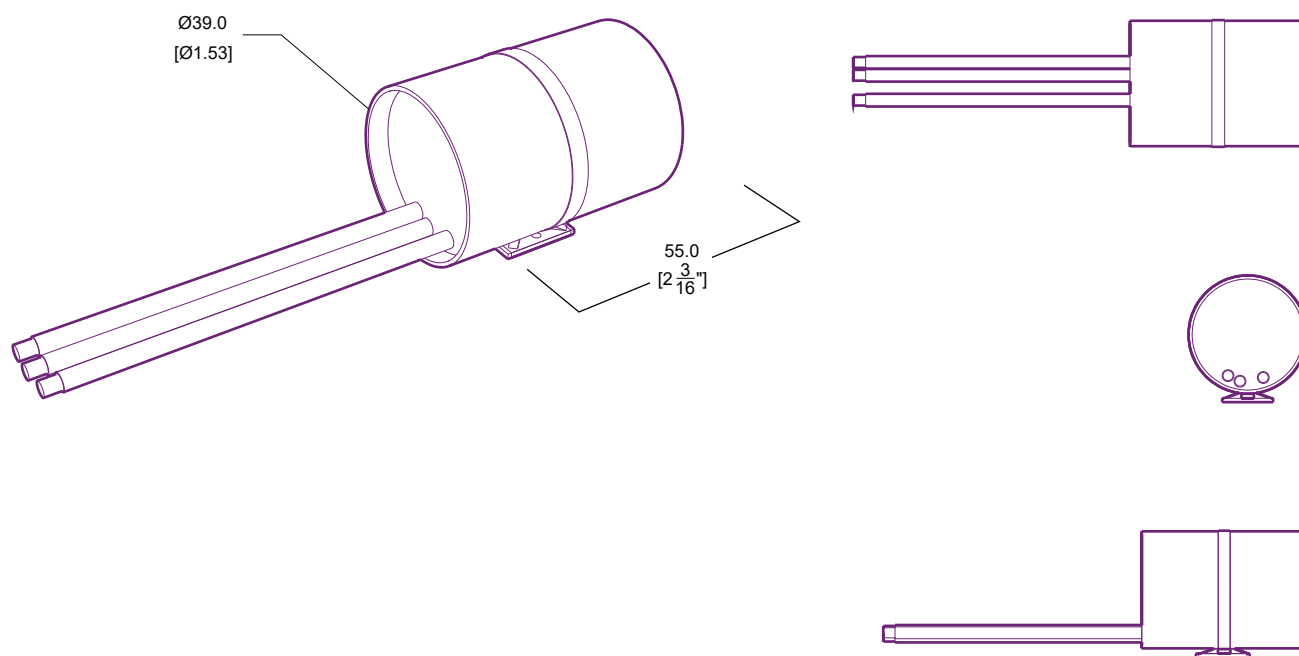

PROJECT

CLIENT

TYPE

Solid State Lighting is sensitive to power fluctuations  
Surge protection is highly recommended for all LED lighting products and should be on a designated circuit to protect against premature failure  
Lack of surge protection may void your warranty

For more information, please download the  
BL LIGHTING catalogue

**BL LIGHTING.** ILLUMINATE EVERYTHING

111 - 8838 Heather St. Vancouver, BC, Canada. V6P 3S8  
P: 1-604-874-4405 F: 1-604-321-0445 E: info@bllighting.com  
Copyright © 2017 BL INNOVATIVE LIGHTING. All Rights Reserved.

bllighting.com

